

Veranda Type

Veranda Style Villas



Traditional plantation-style detached villa with garage, designed in rectilinear form and offering comfortable indoor and outdoor living, elevated terrace and infinity pool set within a lush, tropical landscaped garden.



VILLAS VALRICHE
MAURITIUS

Veranda Type

4 Bedrooms (Ground Floor)

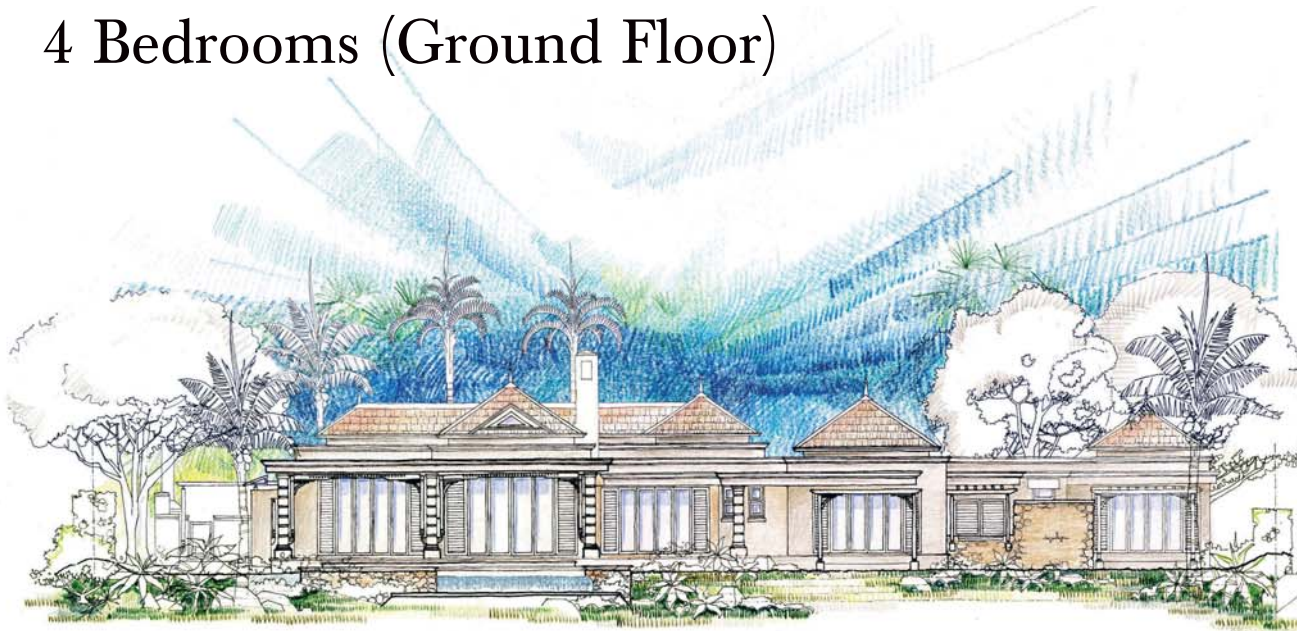

Garden elevation



Legend

1. Entrance
2. Lobby
3. Living Room
4. Dining Room
5. Kitchen
6. Master Suite
7. Bedroom
8. Study/TV
9. Bath
10. Veranda
11. Porch
12. Swimming Pool
13. Terrace
14. Kiosk
15. Bbq
16. Scullery
17. Yard
18. Garage
19. Store
20. Guest Suite

Total Covered Area	382
Total Standard NIA	344
Enclosed Living NIA	229
Ground Floor NIA	229
First Floor NIA	0
Semi Enclosed NIA	98
Entrance Porch	2
Veranda	52
Porch 1	29
Porch 2	15
Enclosed Garage NIA	17
Swimming Pool Swim Area	
Standard	24
Option 1	32
Option 2	40
Options NIA	
Double Garage	18
Store	5
Gazebo	9
Timber Deck	50

Notes:

1. NIA = Net Internal Area.
2. All areas are in square metres.
3. All areas are measured from the internal face of walls for determining NIA and to the outer edge of concrete slabs for Covered Areas
4. Area for store may vary slightly for villas on plots with side access
5. Plan indicated for 0-10% slope
6. Landscaping layout indicative
7. Plan is generic and may vary depending on the selected style and variant

In terms of international norms on measuring standards for marketing purposes: "Covered Area" includes all covered areas measured to the outside of all external walls, covered overhangs and verandas. However in the contract documentation, based on the legal system in Mauritius and prepared by registered Notaries, areas are expressed as NIA (as defined in the glossary of the Specifications document). Depending on the design configuration of each villa, the difference between the "Covered Area" and the "Net Internal Area" will vary between 5% and 15%.

Plan Code: VRN4BG0Y

Veranda Type

4 Bedrooms (Ground Floor)



Garden elevation



SCALE 1:100 0m 2.0m 4.0m

Minimum Site Width 35m

Ground floor plan

Legend

1. Entrance
2. Lobby
3. Living Room
4. Dining Room
5. Kitchen
6. Master Suite
7. Bedroom
8. Study/TV
9. Bath
10. Veranda
11. Porch
12. Swimming Pool
13. Terrace
14. Kiosk
15. Bbq
16. Scullery
17. Yard
18. Garage
19. Store
20. Guest Suite

Total Covered Area	379
Total Standard NIA	341
Enclosed Living NIA	226
Ground Floor NIA	226
First Floor NIA	0
Semi Enclosed NIA	98
Entrance Porch	2
Veranda	52
Porch 1	29
Porch 2	15
Enclosed Garage NIA	17
Swimming Pool Swim Area	
Standard	24
Option 1	32
Option 2	40
Options NIA	
Double Garage	18
Store	5
Gazebo	9
Timber Deck	50

Notes:

1. NIA = Net Internal Area.
2. All areas are in square metres.
3. All areas are measured from the internal face of walls for determining NIA and to the outer edge of concrete slabs for Covered Areas
4. Area for store may vary slightly for villas on plots with side access
5. Plan indicated for 0-10% slope
6. Landscaping layout indicative
7. Plan is generic and may vary depending on the selected style and variant

In terms of international norms on measuring standards for marketing purposes: "Covered Area" includes all covered areas measured to the outside of all external walls, covered overhangs and verandas. However in the contract documentation, based on the legal system in Mauritius and prepared by registered Notaries, areas are expressed as NIA (as defined in the glossary of the Specifications document). Depending on the design configuration of each villa, the difference between the "Covered Area" and the "Net Internal Area" will vary between 5% and 15%.

Plan Code: VRN4VG0Y